

## Use of customer and prepaid cards **BUILT-IN TERMINAL RFID**

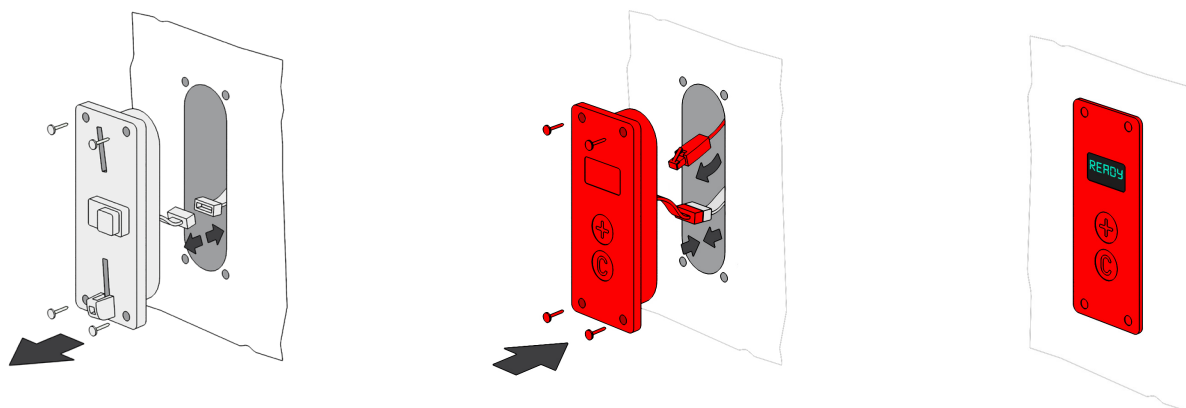

## Use of customer and prepaid cards **BUILT-IN TERMINAL RFID**



### EXCHANGE OF EXISTING COIN SELECTORS

Existing devices (high-pressure cleaners, vacuum cleaners, mat beaters, ...) can be converted to cashless payment with customer and prepaid cards with minimal effort: The existing coin selector is simply exchanged by the dimensionally compatible built-in terminal RFID. Also, the existing device control does not need to be changed: The built-in terminal simulates the coin-insertion pulses expected by the device control when making a card payment.

### DESCRIPTION

Key features include user-friendly operation coupled with reliable RFID card processing and robust overall system functionality. The housing, the vandal-proof buttons and the contactless card technology guarantee wear-free operation outdoors. The terminal processes Beckmann RFID cards, which can be issued, charged or returned at the EMS-4000 cash machines.

### INTERFACE-VERSIONS

- Electronic coin selector
- Coin selector with photocell or micro switch

### FEATURES

- Nonwearing contactless RFID technology
- Vandal-proof buttons for amount preselection
- High-contrast graphic display
- Network connection to EMS-4000 required
- Dimensions (HxWxD): 156 x 64 x 55 mm

### HANDLING PROCEDURE

By pressing the +-button, the amount to be debited can be preselected by the customer. After providing a valid RFID card, the price will be deducted from the card balance and the amount will be sent to the device control via coin impulses. Additional payments by re-holding the RFID card are also possible. With the RFID master card, adjustments can be made to the terminal (e.g. price adjustments) and counters can be read out.

## QUESTIONS? GIVE US A CALL!

Beckmann GmbH  
 Brandtstraße 1  
 33161 Hövelhof  
 Germany

Fon +49 (0) 52 57-98 23-0  
 Fax +49 (0) 52 57-98 23-11  
 info@beckmann-gmbh.de  
 www.beckmann-gmbh.de