

Solutions for **CAMPING SITES & RV PARKS**



Energy tower
EMS-ENERGY

Fresh water tower
EMS-WATER

Disposal tower
EMS-CLEAN

Energy tower **EMS-ENERGY**



EMS-ENERGY 4 Master



EMS-ENERGY 4 Slave

Energy tower EMS-ENERGY

DESCRIPTION

The innovative energy tower EMS ENERGY provides a reliable power supply for motor homes and caravans on camping sites and RV parks. The use of stainless steel combined with a small footprint provide a modern and attractive design. Over and above that, the robust construction and the use of high quality components lead to a long product life, less service expenditure and very good weather resistance.

OPERATION

The select buttons for the individual sockets are positioned directly below the display in economic height. The status LEDs above the buttons clearly indicate with red and green colours, which sockets are occupied or free.

After selecting a free socket and inserting a coin or paying by NFC-card, the available power amount is displayed in kWh and released. The EMS ENERGY convinces by an intuitive user guidance and easy handling during the whole sale process.

Counters and parameters (prices, amounts of energy,...) can be easily accessed and adjusted by the site owner after entering the local system modus at each tower.

SUPPLY OF UP TO 8 SITES

The DIN VDE 0100-708 from 01.04.2012 prescribes that a maximum of 4 sockets are allowed per tower. Due to the optional combination of master and slave tower, up to 8 sockets (4 Slave, 4 Master) can be supplied with only one control unit. The selection and payment of all 8 sockets are centralized at the EMS-ENERGY master tower. The master-slave concept reduces acquisition costs and facilitates the local distribution of towers on the available site space.



QUESTIONS?

GIVE US A CALL!

Beckmann GmbH
 Brandtstraße 1
 33161 Hövelhof
 Germany

Fon +49 (0) 52 57-98 23-0
 Fax +49 (0) 52 57-98 23-11
 info@beckmann-gmbh.de
 www.beckmann-gmbh.de

FEATURES

- numbered CEE sockets 16A 230V with separate buttons & status LED (green = free, red = busy)
- robust and weather resistant stainless steel housing
- encapsulated electronics
- main switch, RCBOs and calibrated meters for a Standard-compliant operation
- individually readable meters with backlight
- large display for information, e.g. remaining energy, rates and parameters
- intuitive operation by plug selection and coin insertion
- electronic coin selector 0,10 EUR to 2,- EUR and tokens
- protected coin cassette with solid stainless steel collar and security lock
- dimensions Master (HxWxD): 1300 x 260 x 275 mm
 dimensions Slave (HxWxD): 1017 x 100 x 100 mm

OPTIONS

- Terminal for cashless payments without PIN entry
 - Acceptance of NFC bank cards & smartphones
 - SIM card and antenna for wireless data transmission
 - Remote display of sales data
- Contactless payment by Beckmann RFID card
- LED illumination of front and sockets for night operation

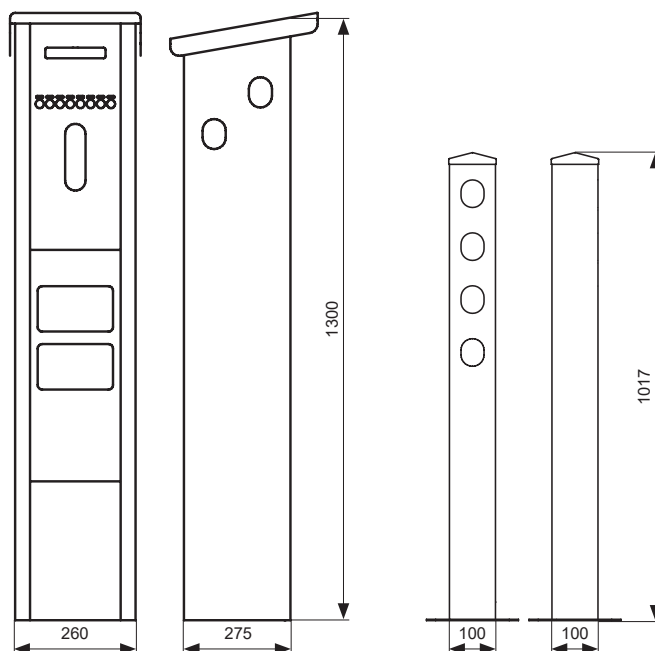

Fresh water tower **EMS-WATER**



Fresh water tower EMS-WATER

DESCRIPTION

The innovative water tower allows an easy, ergonomic and reliable fresh water supply for motor homes and caravans on camping sites and RV parks. The use of stainless steel combined with a small footprint provide a modern and attractive design. Over and above that, the robust construction and the use of high quality components lead to a long product life, less service expenditure and very good weather resistance.

OPERATION

After inserting a coin or paying by NFC-card, the available amount of water is displayed. By pressing the start/stop button, the delivery process is activated and the water flows out of the faucet. The delivery can be stopped at any time by pressing the start/stop button again. The EMS-WATER convinces by an intuitive user guidance and easy handling during the whole sale process. Cash reports and parameters (prices, amounts of energy,...) can be easily accessed and adjusted by the site owner after entering the local system modus at each tower.

FEATURES

- 1x fresh water connection, Gardena-system adapted
- Calibrated water meter, typical flow 2,5m³ / h
- Maximum 5,0m³ / h, nominal pressure PN16
- Automatic hygiene flushing
- Robust and weather resistant stainless steel housing
- Info display for remaining time and parameters
- Intuitive operation
- Encapsulated electronics
- Electronic coin selector 0,10 EUR to 2,- EUR and tokens
- Dimensions (HxWxD): 1300 x 260 x 275 mm

OPTIONS

- Terminal for cashless payments without PIN entry
 - Acceptance of NFC bank cards & smartphones
 - SIM card and antenna for wireless data transmission
 - Remote display of sales data
- Contactless payment by Beckmann RFID card
- LED illumination for night operation
- Winter kit with pipe heating

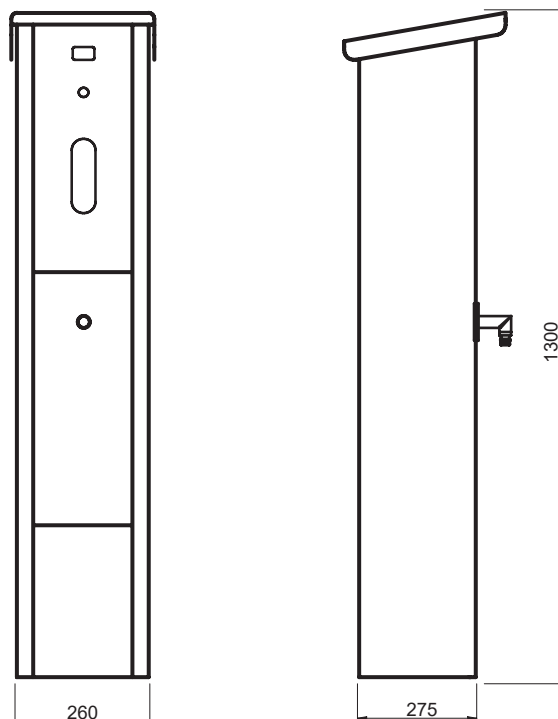

QUESTIONS? GIVE US A CALL!

Beckmann GmbH
Brandtstraße 1
33161 Hövelhof
Germany

Fon +49 (0) 52 57-98 23-0
Fax +49 (0) 52 57-98 23-11
info@beckmann-gmbh.de
www.beckmann-gmbh.de

Disposal tower **EMS-CLEAN**



Disposal tower EMS-CLEAN

DESCRIPTION

The innovative disposal tower allows an easy, ergonomic and clean emptying process of cassette toilets. The use of stainless steel combined with a small footprint provide a modern and attractive design. Over and above that, the robust construction and the use of high quality components lead to a long product life, less service expenditure and very good weather resistance.

OPERATION

After inserting a coin or paying by NFC-card the available usage time is displayed. By opening the disposal flap, the countdown of the available time is activated and the cleaning process is started: During this time, the continuous flush is activated so that the cassette toilet can be emptied clean and simple.

Afterwards, the cassette toilet can be flushed with water by positioning the spout under the fauced and by pressing the flat foot switch near the ground. After finishing the disposal process the flap can be closed to reduce odors.

FEATURES

- Innovative drain construction with integrated flush
- Extra fauced with ergonomic foot switch activation
- Robust and weather resistant stainless steel housing
- Intuitive operation
- Encapsulated electronics
- Info display for remaining time and parameters
- Electronic coin selector 0,10 EUR to 2,- EUR and tokens
- Dimensions (HxWxD): 1300 x 260 x 275 mm

OPTIONS

- Terminal for cashless payments without PIN entry
 - Acceptance of NFC bank cards & smartphones
 - SIM card and antenna for wireless data transmission
 - Remote display of sales data
- Contactless payment by Beckmann RFID card
- LED illumination for night operation
- Winter kit with pipe heating
- Flush control for external bottom valve

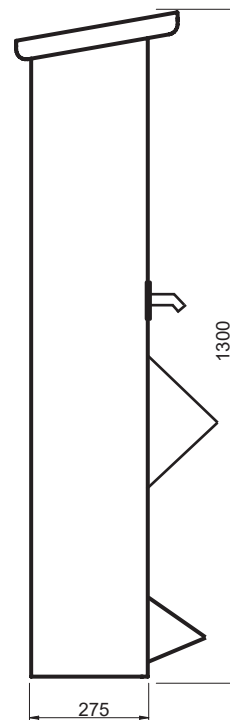
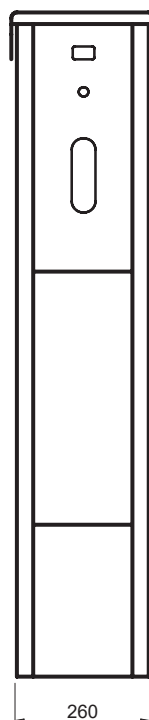

Figure:
Disposal flap in open and closed state

QUESTIONS? GIVE US A CALL!

Beckmann GmbH
Brandtstraße 1
33161 Hövelhof
Germany

Fon +49 (0) 52 57-98 23-0
Fax +49 (0) 52 57-98 23-11
info@beckmann-gmbh.de
www.beckmann-gmbh.de



EMS-CLEAN

Operating procedure

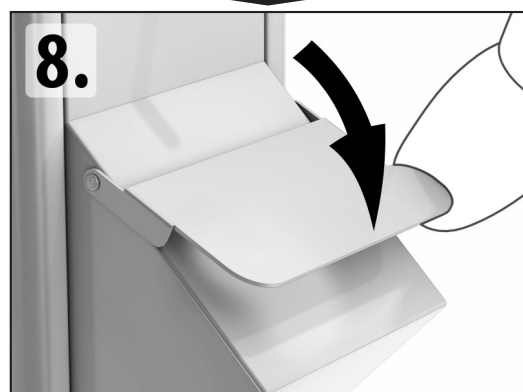
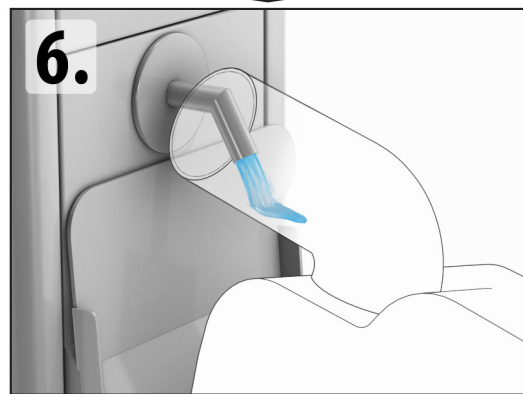
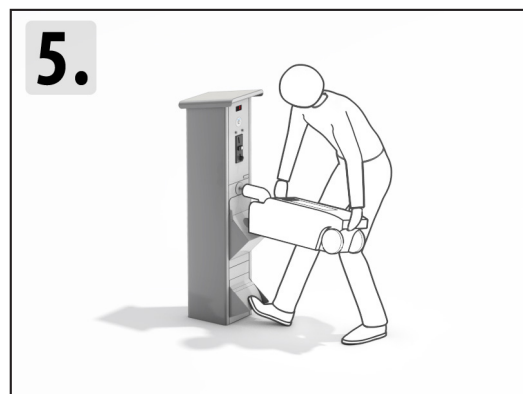
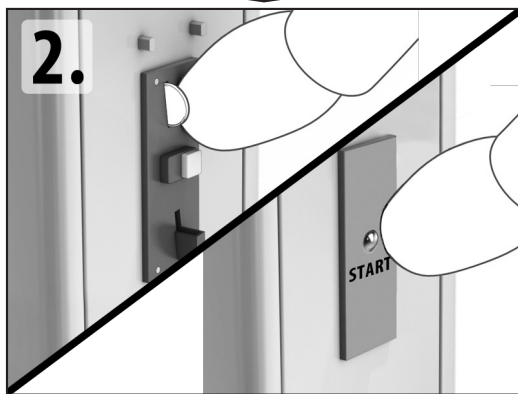
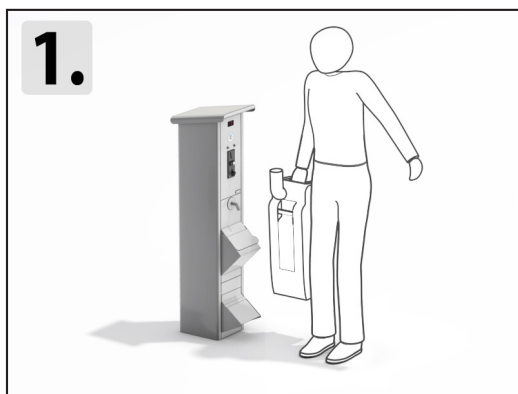

EMS-CLEAN-SYSTEM

Supply and disposal place

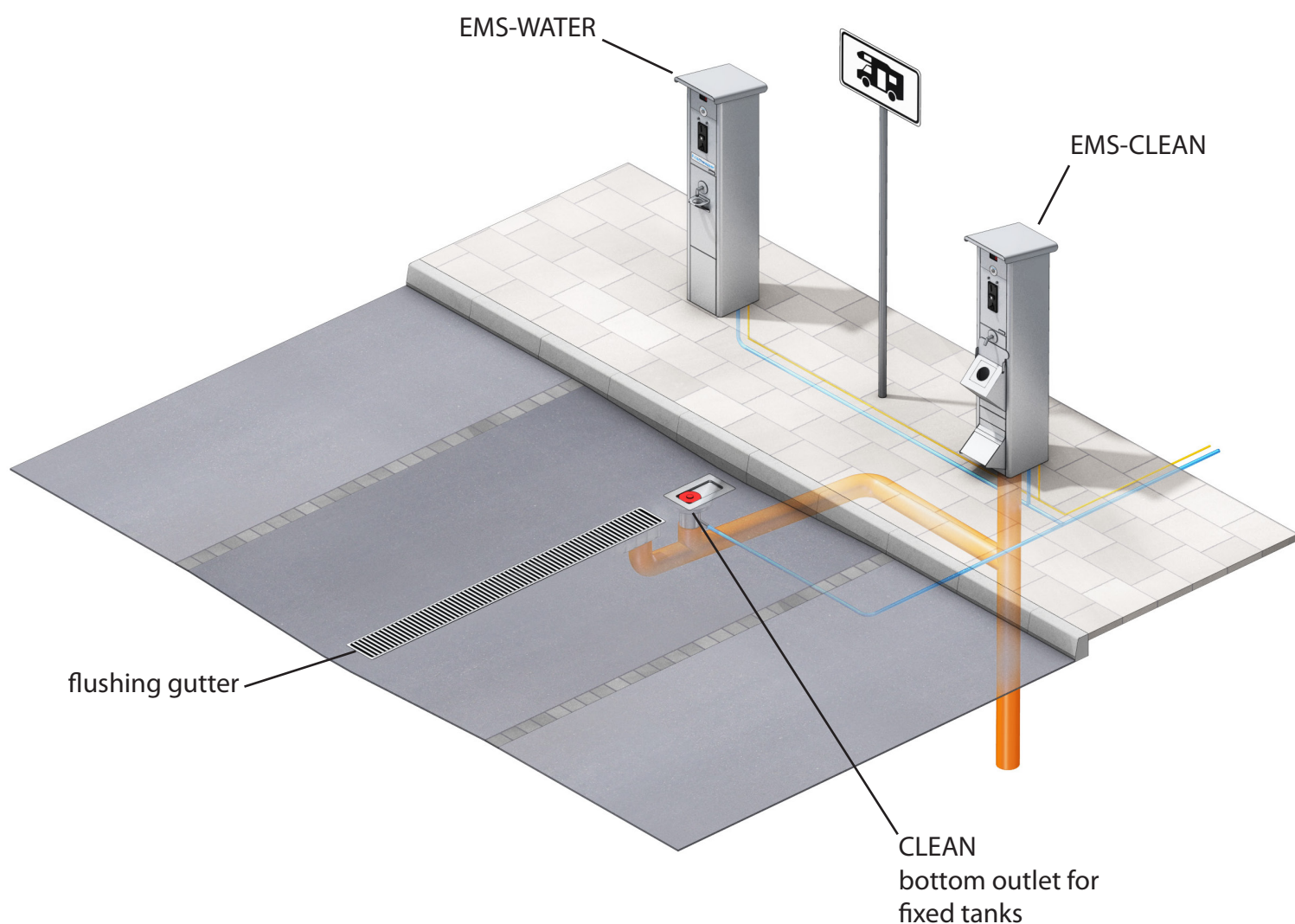

QUESTIONS?
GIVE US A CALL!

Beckmann GmbH
Brandtstraße 1
33161 Hövelhof
Germany

Fon +49 (0) 52 57-98 23-0
Fax +49 (0) 52 57-98 23-11
info@beckmann-gmbh.de
www.beckmann-gmbh.de

QUALITY
MADE IN GERMANY
MADE IN GERMANY

Parking terminal

Ticketdispenser for parkings



Parking terminal

Ticketdispenser for parkings

DESCRIPTION

Fast handling and easy operation are the key requirements when entering or leaving a parking space. Our elegant stainless steel parking towers support the idea of an intuitive guidance by focusing on the essentials: color graphic display, illuminated push button and a single ticket slot for all tickets. The driver is guided by on-screen instructions and multicoloured LEDs on the button and around the ticket slot. In the case of additional questions or problems, the driver can contact a service center by pushing the integrated intercom button. The integrated hybrid motor reader is used both for in- and output of cost-effective barcode tickets. RFID cards (e.g. for robust season or special tickets) can be processed, too.

OPERATION

If a car is placed over the loop sensor of the connected barrier, the driver can trigger two options to open the barrier: Either to request a paper barcode ticket by pressing the illuminated button or to insert a Beckmann RFID card for special functions (e.g. local resident entry).



Figure:
Large backlit colour display



QUESTIONS?
GIVE US A CALL!

Beckmann GmbH
Brandtstraße 1
33161 Hövelhof
Germany

Fon +49 (0) 52 57-98 23-0
Fax +49 (0) 52 57-98 23-11
info@beckmann-gmbh.de
www.beckmann-gmbh.de

FEATURES

- Robust and weather resistant stainless steel housing
- Elegant design
- Large backlit colour display for customer information
- Large illuminated request button
- Intuitive operation and fast ticket processing
- One ticket slot for in- and output of tickets
- Hybrid motor reader for barcode and RFID tickets
- Encapsulated electronics
- LED illumination for night operation
- Communication via RJ45 ethernet connection
- Optional integrated intercom unit
- Optional traffic light control
- Dimensions (HxWxD): 1100 x 260 x 275 mm

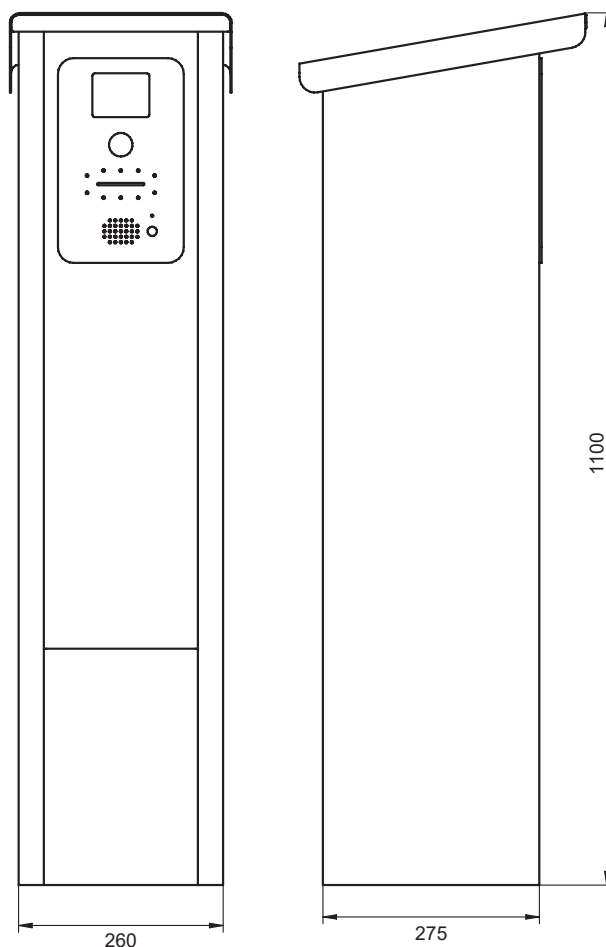

Pay station **EMS-4000**



Pay station EMS-4000

DESCRIPTION

Intuitive and user-friendly operation, minimized operational and maintenance costs, simple and secure data management: these key features are realized with the performant and reliable EMS-4000 pay station which combines the experience of over 30 years cash processing with our know-how in software and hardware development. Beside its numerous hardware equipment options, the system can be individualized by its configurable software to meet the customer needs at its best. Based on this flexible architecture, further modifications can be realized to meet challenges of the future. The EMS-4000 accepts coins, tokens, banknotes and cashless payment via card for payment.

A combination of tube changer (with six individual definable coin tubes) and coin hopper (both self-refilling) guarantee a maximum period of time to refill to reduce service expenditures. For the output of barcode tickets, vouchers, receipts or cash reports, the EMS-4000 is equipped with a thermal printer. Optional, RFID-value cards can be bought, loaded and dispensed for a subsequent use as cashless payment and wear-free medium at BECKMANN components (e.g. RFID-Terminal, EMS-ENERGY etc.). With the use of RFID-value cards, discounts and promotions can be realized to strengthen customer loyalty. If the credit is expended, the RFID card can be recharged or returned at EMS-4000. Over and above that, the robust and secure steel housing and the use of high quality components (e.g. safe lock with special locking mechanism, stainless steel buttons,...) lead to a long product life, less service expenditure and very good weather resistance. The elegant EMS-4000 can be mounted on wall or detached on an optional pillar. All electronic modules are equipped with a powerful processor which is driven by an own developed, programmed and optimized operating system Beckmann OS. By eliminating additional PC components, the operating system convinces through reliability, serviceability and security. A webinterface provides status information and allows an intuitive parameter configuration via remote access. Further, a detailed analysis of sales data is possible by using the optional software EMS-DATA.

QUESTIONS?

GIVE US A CALL!

Beckmann GmbH
 Brandtstraße 1
 33161 Hövelhof
 Germany

Fon +49 (0) 52 57-98 23-0
 Fax +49 (0) 52 57-98 23-11
 info@beckmann-gmbh.de
 www.beckmann-gmbh.de



Figure:

Self-refilling tube changer and coin hopper

TECHNICAL DATA

- 10" TFT-colour-display
- Multicoloured LEDs with status indication
- 8x robust vandal-proof buttons
- Self-refilling tube changer (6x coin tubes)
- Self-refilling coin dispenser with large capacity (e.g. 1€ hopper = 600 coins)
- Banknote reader (all directions)
- Thermal printer (e.g. for tickets, vouchers, receipts)
- Safe lock with a special locking mechanism
- Web-Interface for remote-access and parameter settings
- Surface galvanized and powder coated
- Colour housing: Tiger P7
 Colour stainless-steel front: Sparkling Silver New
- Dimensions (HxWxD): 1140 x 513 x 393 mm

OPTIONS

- Cashless payment cardterminal
- RFID-value card dispenser
- 2nd coin dispenser with large capacity
- GFG touchscreen
- Security coin-box (self-closing)
- Alarm contacts, intercom
- Pillar, illuminated roof-top, outdoor package
- Statistics software EMS-DATA

Pay station **EMS-800**



Pay station EMS-800

VERSIONS

The EMS-800 can be individualized by its numerous equipment options to meet the individual customer needs at its best. The following versions are available:

- Banknote exchanger
- Voucher and ticket dispenser
- Token dispenser
- Cash system for controlled access

DESCRIPTION

The robust and multifunctional EMS-800 is featured by an intuitive, user-friendly operation combined with a reliable banknote processing. This machine is ideal, when coins, tokens and banknotes shall be accepted for payment. Up to three integrated coin hoppers guarantee a maximum of flexibility and reduce service expenditures. In addition, contactless micropayments with bank cards or smartphones up to 25€ can be processed without entering a pin.

For the output of vouchers, receipts or cash reports, the EMS-800 can be equipped with an optional thermal printer. A security hologram strip on the voucher serves as copy protection in order to prevent abuse.

The bright, high-contrast TFT color display and multicoloured LEDs support an intuitive operation and user guidance. Over and above that, the robust construction and the use of high quality components (e.g. stainless steel buttons) lead to a long product life, less service expenditure and very good weather resistance.

TECHNICAL DATA

- 5,7" TFT-colour-display
- Multicoloured LEDs with status indication
- 6x robust stainless steel buttons
- Safe lock with a special locking mechanism
- Electronic coin selector 0,10 EUR to 2,- EUR and tokens
- Up to 3 selectable coin dispenser with large capacity (e.g. 1€ hopper = 600 coins)
- Banknote reader (all directions)
- Return and/or exchange of coins possible
- Optional creditcard-terminal for cashless payment with chip/NFC up to 25€ w/o pin (Micropayment)
- Optional RFID-value card dispenser
- Thermal printer for vouchers, receipts or cash reports
- integrated RFID reader for special functions (e.g. free entry for staff, programming modus,...)
- Optional pillar, outdoor package with heating
- Optional statistics software EMS-DATA
- Comfortable parameter configuration via display
- Surface galvanized and powder coated
- Colour housing: Tiger P7
- Colour stainless-steel front: Sparkling Silver New
- Dimensions (HxWxD): 750 x 440 x 350 mm



Figure:
Selection screen, version parking ticket

QUESTIONS? GIVE US A CALL!

Beckmann GmbH
 Brandtstraße 1
 33161 Hövelhof
 Germany

Fon +49 (0) 52 57-98 23-0
 Fax +49 (0) 52 57-98 23-11
 info@beckmann-gmbh.de
 www.beckmann-gmbh.de

Pay station **EMS-700**



Pay station EMS-700

DESCRIPTION

Beckmann offers with the EMS-700 a compact coin payment solution, e.g. for the controlled access in public areas, leisure facilities and in sanitary blocks in combination with door openers, turnstiles or gates. Further applications can be realized by selling vouchers which can be redeemed afterwards at a counter, e.g. in a cafeteria or in a barbershop. Fast handling and an intuitive operation are the key requirements for this reliable cash system.

The EMS-700 is equipped with a self-refilling tube changer with high capacity (six individual definable coin tubes) which accepts coins from 0.10 to 2.00 EUR and tokens. The use of this machine is ideal, when a return of coins respectively an exchange of coins are required. For the output of vouchers, receipts or cash reports, the EMS-700 is equipped with a thermal printer. A security hologram strip on the voucher serves as copy protection in order to prevent abuse.

The bright, high-contrast TFT color display and multicoloured LEDs support an intuitive operation and user guidance. Over and above that, the robust construction and the use of high quality components (e.g. stainless steel buttons) lead to a long product life, less service expenditure and very good weather resistance.

Special functions (e.g. free entry for staff, programming modulus,...) can be realized by using the integrated RFID reader which is integrated in the front of the EMS-700. An online data interface allows the analysis of sales data and status information with the optional software EMS-DATA.

TECHNICAL DATA

- 2,5" TFT-colour-display
- 6x robust stainless steel buttons
- Safe lock with a special locking mechanism
- Acceptance of coins from 0.10 to 2.00 EUR and tokens
- Self-refilling tube changer (6x coin tubes)
default combination EUR23
1x 10Ct / 1x 20Ct / 2x 50Ct / 2x 1€
- Multicoloured LEDs with status indication
- Return and/or exchange of coins possible
- Optional creditcard-terminal for cashless payment
with chip/NFC up to 25€ w/o pin (Micropayment)
- thermal printer for vouchers, receipts or cash reports
- integrated RFID reader for special functions
(e.g. free entry for staff, programming modulus,...)
- Optional pillar, outdoor package with heating
- Optional statistics software EMS-DATA
- Comfortable parameter configuration via display
- Surface galvanized and powder coated
- Colour housing: Tiger P7
Colour stainless-steel front: Sparkling Silver New
- Dimensions (HxWxD): 750 x 350 x 220 mm



Figure:
Voucher with security hologram strip



QUESTIONS?
GIVE US A CALL!

Beckmann GmbH
Brandtstraße 1
33161 Hövelhof
Germany

Fon +49 (0) 52 57-98 23-0
Fax +49 (0) 52 57-98 23-11
info@beckmann-gmbh.de
www.beckmann-gmbh.de

 **QUALITY**
MADE IN GERMANY
MADE IN GERMANY

Cashless payment with customer-cards

RFID-TERMINAL



Cashless payment with customer-cards

RFID-TERMINAL

DESCRIPTION

This splash-proof RFID terminal is designed for on-wall mounting, making it ideal for harsh environmental conditions. The rugged housing, the capacitive touch buttons and the contactless RFID- technology ensure a wear-free operation. Likewise, the cash-free operation reduces the risk of break up and theft. The terminal can be used for

- Access function (door opener)
e.g. for controlled access to sanitary facilities
- Pay station (cash card function)
e.g. for the activation of washing machines / showers

MEDIA

The RFID-terminal processes RFID tickets which are issued at the entrance parking terminals. As an alternative to databased online operation, RFID value cards can also be used in offline mode. These value cards can be dispensed, recharged or returned at the self-service cash systems EMS-800 or EMS-4000. Furthermore, one-way RFID paper tickets can also be used which are pre-programmed with a defined number of use or credit. After the credit is exhausted, these tickets can be simply disposed of.

HANDLING PROCEDURE

After holding an RFID ticket or card to the terminal, credit is debited and the connected device is activated for the stored time period. By using the RFID master card, settings (e.g. time and prices) can be programmed as well as counters can be read out.

TECHNICAL DATA

- Nonwearing contactless RFID technology
- High-contrast graphic display (H x W): 38 x 65 mm
- RGB-LEDs and acoustic feedback
- 4 capacitive touch-buttons beside the display
- Ergonomic inclination for comfortable operation
- Encapsulated housing for rough outdoor environment
- Cashless payment with RFID plastic cards and preloaded RFID paper tickets (one-way)
- Autarch offline operation by local storage of credit on encrypted RFID cards and tickets
- No network connection or server required
- Operating voltage 230V AC
- Control of up to 2 devices with one RFID-terminal
- Relay switching capacity 16A AC1 or potential-free, NC and NO contacts available
- Potential-free input for backpulses of devices available
- Transparent operating front (material PC-FR, impact resistant)
- Graphite gray plastic housing (material PC-FR, impact resistant)
- Wall bracket (material VA stainless steel, powdered RAL 7024)
- Weight: 1,1 kg

VARIANTS

- Control of one device (1x output relay)
- Control of two devices (2x output relay)

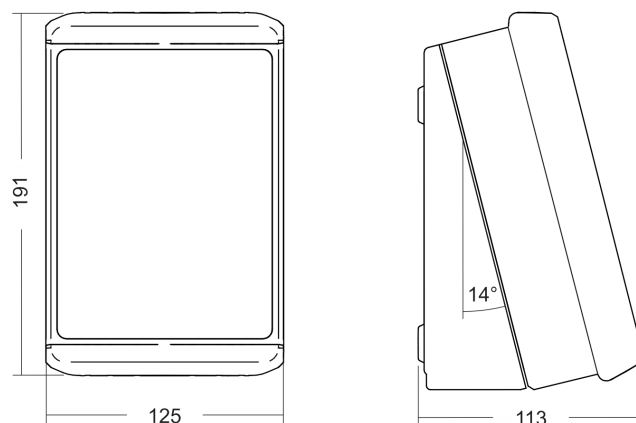

QUESTIONS?

GIVE US A CALL!

Beckmann GmbH
 Brandtstraße 1
 33161 Hövelhof
 Germany

Fon +49 (0) 52 57-98 23-0
 Fax +49 (0) 52 57-98 23-11
 info@beckmann-gmbh.de
 www.beckmann-gmbh.de

 **QUALITY**
 MADE IN GERMANY
 MADE IN GERMANY

Universal payment of up to 8 devices **EMS-1080**



EMS-1080 operating unit with RFID-card-terminal
(Payment with prepaid customer card credit)

EMS-1080 operating unit with card-terminal and coin selector
(ONLINE-payment up to 25€ per transaction)

Universal payment of up to 8 devices

EMS-1080

DESCRIPTION

The system family EMS-1080 is developed for the central control of up to eight devices (e.g. washing machines, dryers, showers, toilet doors,...). The payment can be transacted either with coins or credit cards or loaded RFID-customer-cards. The use of stainless steel, a robust construction and the use of high quality components lead to a long product life, less service expenditure and very good weather resistance.

HANDLING PROCEDURE

The individual status RGB-LEDs clearly indicate, which devices are occupied or free. After choosing a free device, the large display shows the individual minimum amount of insertion. After the payment is completed, the selected device is switched on for the stored time period. After the program time has elapsed, an optional door opening pulse is available.

An EMS-1080 system consists of two components:

- Operating unit (for selection, payment, configuration)
- PowerBox (power supply, relais I/Os)



Figure:
Separated PowerBox

QUESTIONS?
GIVE US A CALL!

Beckmann GmbH
Brandtstraße 1
33161 Hövelhof
Germany

Fon +49 (0) 52 57-98 23-0
Fax +49 (0) 52 57-98 23-11
info@beckmann-gmbh.de
www.beckmann-gmbh.de

PAYMENT OPTIONS

- Electronic coin selector 0,10 EUR to 2,- EUR and tokens
- creditcard-terminal for cashless payment with chip/NFC up to 25€ w/o pin (Micropayment)
- RFID-customer-card-terminal

The inexpensive card terminal handles contactless cashless payment by simply holding the card or smartphone in front of it without entering a PIN. The integrated SIM card ensures wireless data transmission. Furthermore, the operator has the possibility to monitor sales and device status remotely.

RFID-CUSTOMER-CARDS

The customer card terminal processes Beckmann-RFID-plastic cards that can be issued, recharged or returned at the pay station EMS-4000. Alternatively, one-way RFID tickets can be used on the EMS-1080, which are pre-programmed with a defined number of uses.

TECHNICAL DATA - Operating unit

- Weatherproof stainless steel housing
- Robust stainless steel buttons and multicoloured status LEDs
- Access to cash and hour meters
- OS on exchangeable controller chip
- Supply voltage: supply with low voltage from powerbox
- Dimensions (HxWxD): 300 x 320 x 155mm

TECHNICAL DATA – PowerBox

- Supply voltage: 230VAC, 50 / 60Hz
- Number of relay outputs (NO): 4x (EMS-1040)
8x (EMS-1080)
- Switching capacity per relay: 16A, 250VAC
- Dimensions (HxWxD): 175 x 175 x 80mm (EMS-1040)
- Dimensions (HxWxD): 180 x 250 x 65mm (EMS-1080)

Coin machines
EMS-5x/EMS-8x



Coin machine EMS-57

Coin machines

EMS-5x/EMS-8x

DESCRIPTION

With the EMS-5x and EMS-8x series of coin machines, any services can be easily time-controlled by coin or token. The bright and clear display informs concerning the inserted coins or the remaining time. For the optional use in outdoor / wet area, we offer a robust stainless steel housing, encapsulated electronics and 24V AC SELV.

While the EMS 5x represents the entry-level model for simple applications, the EMS-8x shows its strengths through several settings and flexible applications.

BENEFITS EMS-8x

- Extensive settings, comfortable adjustable via display
- Integrated counters (cash counter, hour meter,...), easy accessible via display
- Electronic coin selector: 0,10 EUR to 2,- EUR and tokens (EMS 82)
- Application-specific versions (e.g. for washing machines, showers, toilet access, solarium, pulse counters, ...)
- Powerful microprocessor
- Modern SMD technology
- Software updates via optional SD-card module possible













EMS-57



EMS-81



EMS-82

Coin selector	MP = Mechanical coin selector EMP = Electronic coin selector	EMS-57	EMS-81	EMS-82
		MP 1 type of coin	MP 1 type of coin	EMP several coin types
Display	LED-Display	3-digits, green Remaining time	3-digits, red Remaining time	3-digits, red Remaining time
Settings	Minimum insertion, price, timing	via DIP-switches	comfortable via display	comfortable via display
Integrated counters	Cash counter, hour meter, customer counter accessible via display	-		
Version	TE door unlocking - for washing machines and dryers - additional payment during operation			
	SO solarium - redundant switch-off reliability - switch-on delay - remote start	-		
	DU showers - start/stop-button - hygiene flushing	-		
	IM impulse (water/energy) - impulse counter for energy- and water - delivery with start/stop function	-	-	
	WC toilet access - potential-free contact - display FREE / OCCUPIED	-	-	
Housing		Steel metal	Steel metal, stainless steel optional	
Operating voltage (switching capacity)		230V (16 A/AC1)	230V (16 A/AC1), 24V AC SELV optional	
Dimensions (HxWxD)		260 x 160 x 110 mm		



QUESTIONS?

GIVE US A CALL!

Beckmann GmbH
Brandstraße 1
33161 Hövelhof
Deutschland

Fon +49 (0) 52 57 -98 23 -0
Fax +49 (0) 52 57 -98 23 -11
info@beckmann-gmbh.de
www.beckmann-gmbh.de